

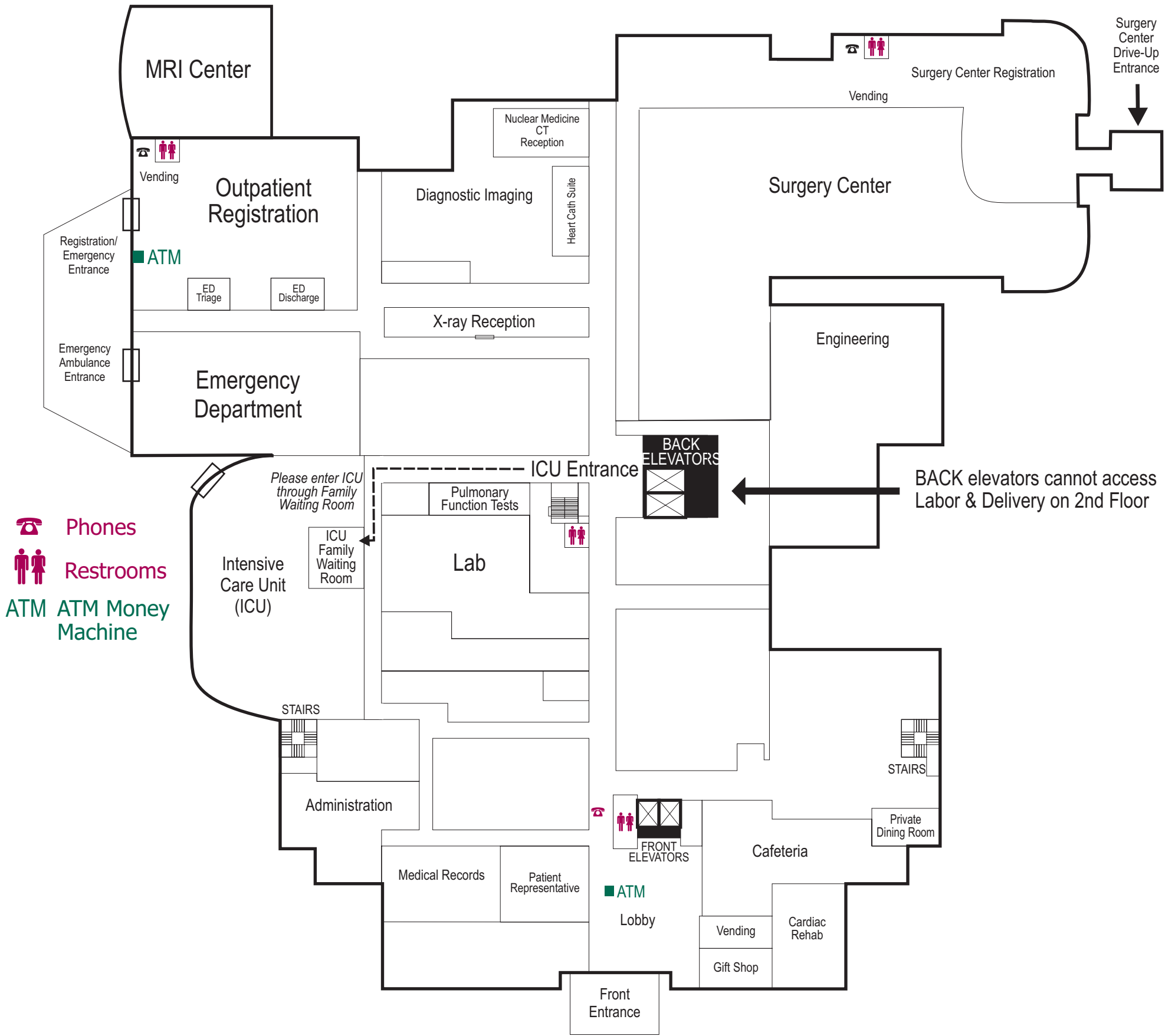

# Frankfort

REGIONAL MEDICAL CENTER



Please use FRONT ELEVATORS for labor and delivery.

Please use BACK ELEVATORS for mammography, ultrasound, echo and second floor classroom.

# 1ST Floor LOBBY



# Frankfort

REGIONAL MEDICAL CENTER

Because of our Infant Security System, mammography, ultrasound, echo and the second floor classroom can only be accessed from the back elevators located on the main hallway

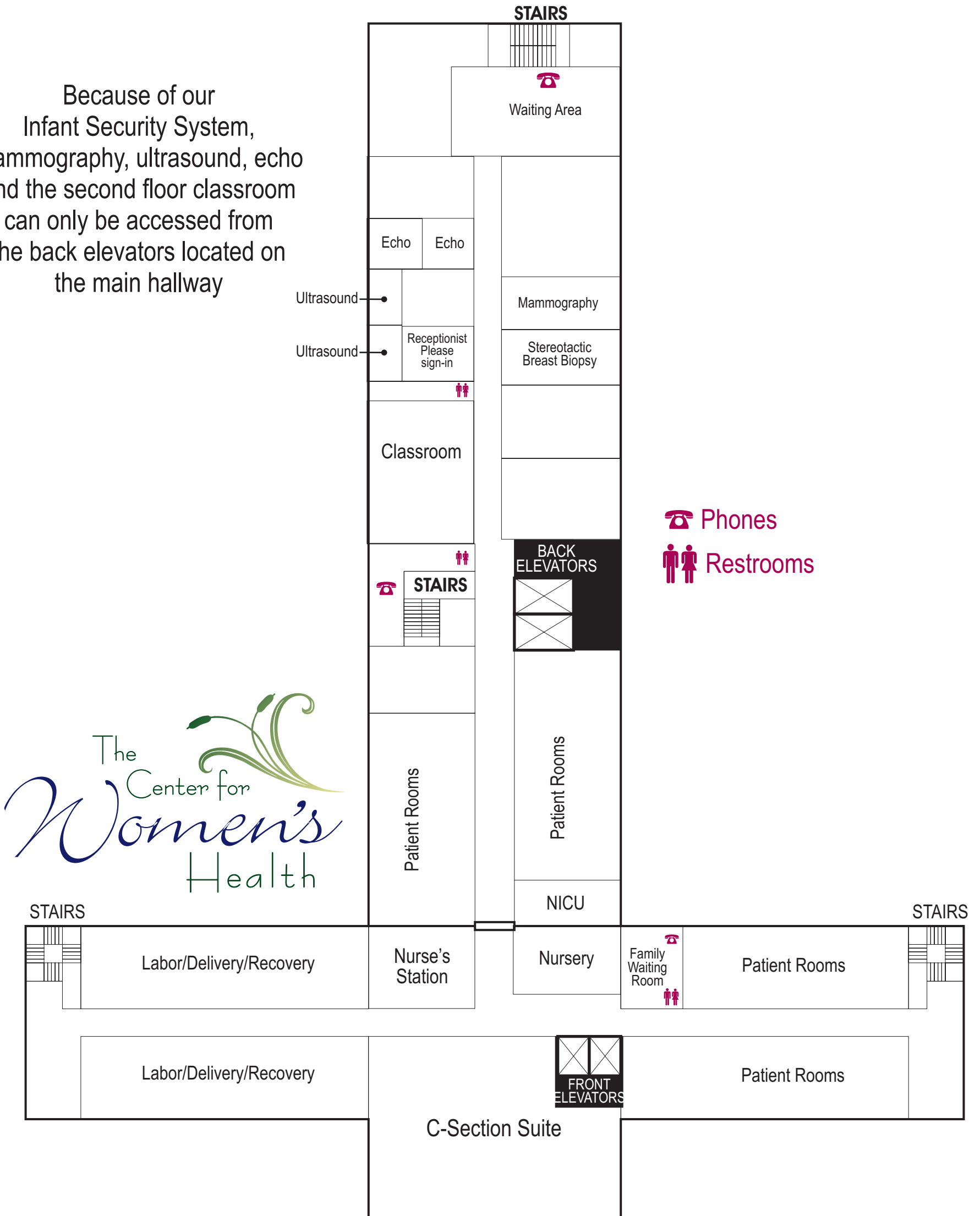

☎ Phones  
🚻 Restrooms

# 2<sup>ND</sup> FLOOR



# Frankfort

REGIONAL MEDICAL CENTER

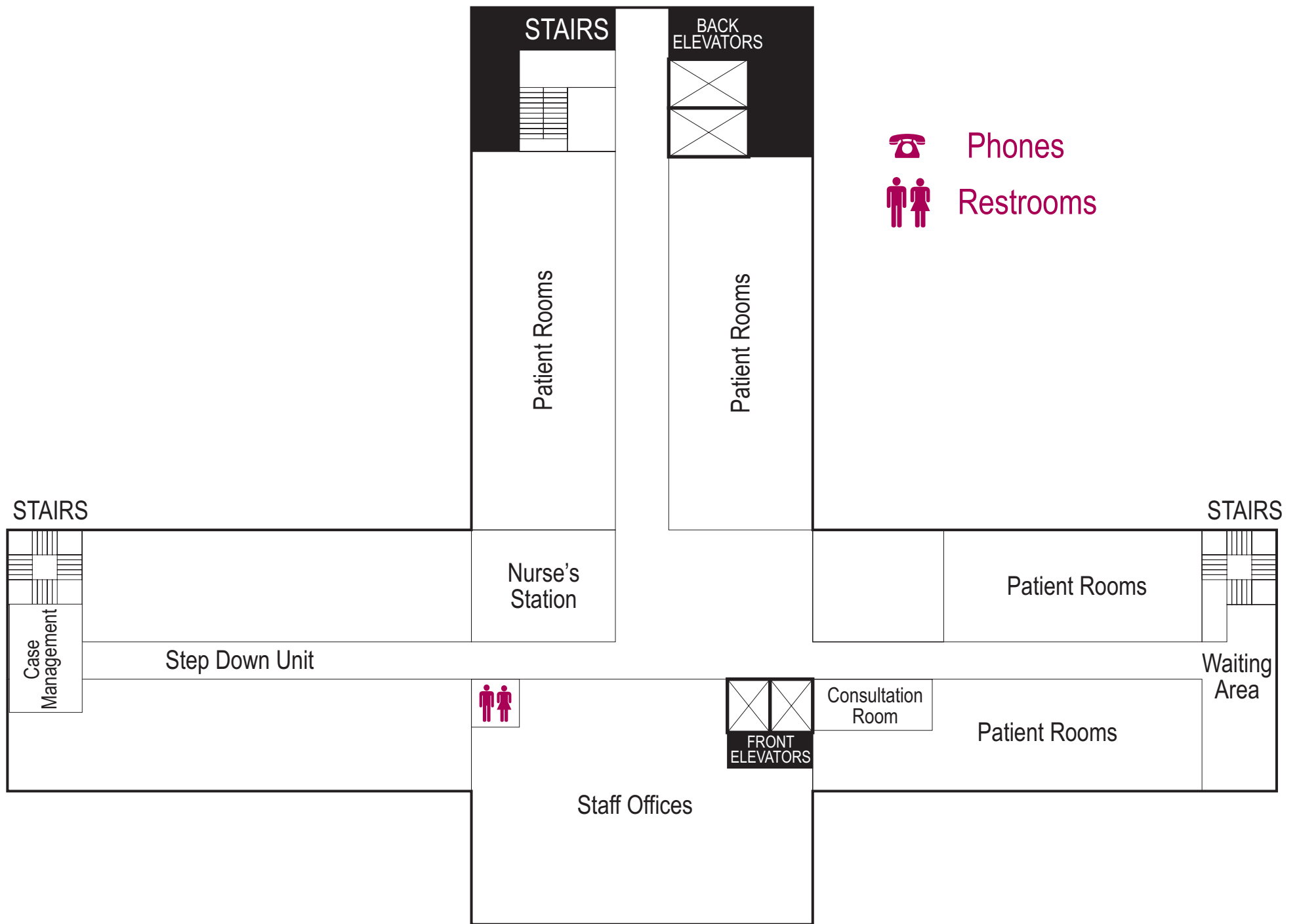

# 3<sup>RD</sup> FLOOR



# Frankfort

REGIONAL MEDICAL CENTER

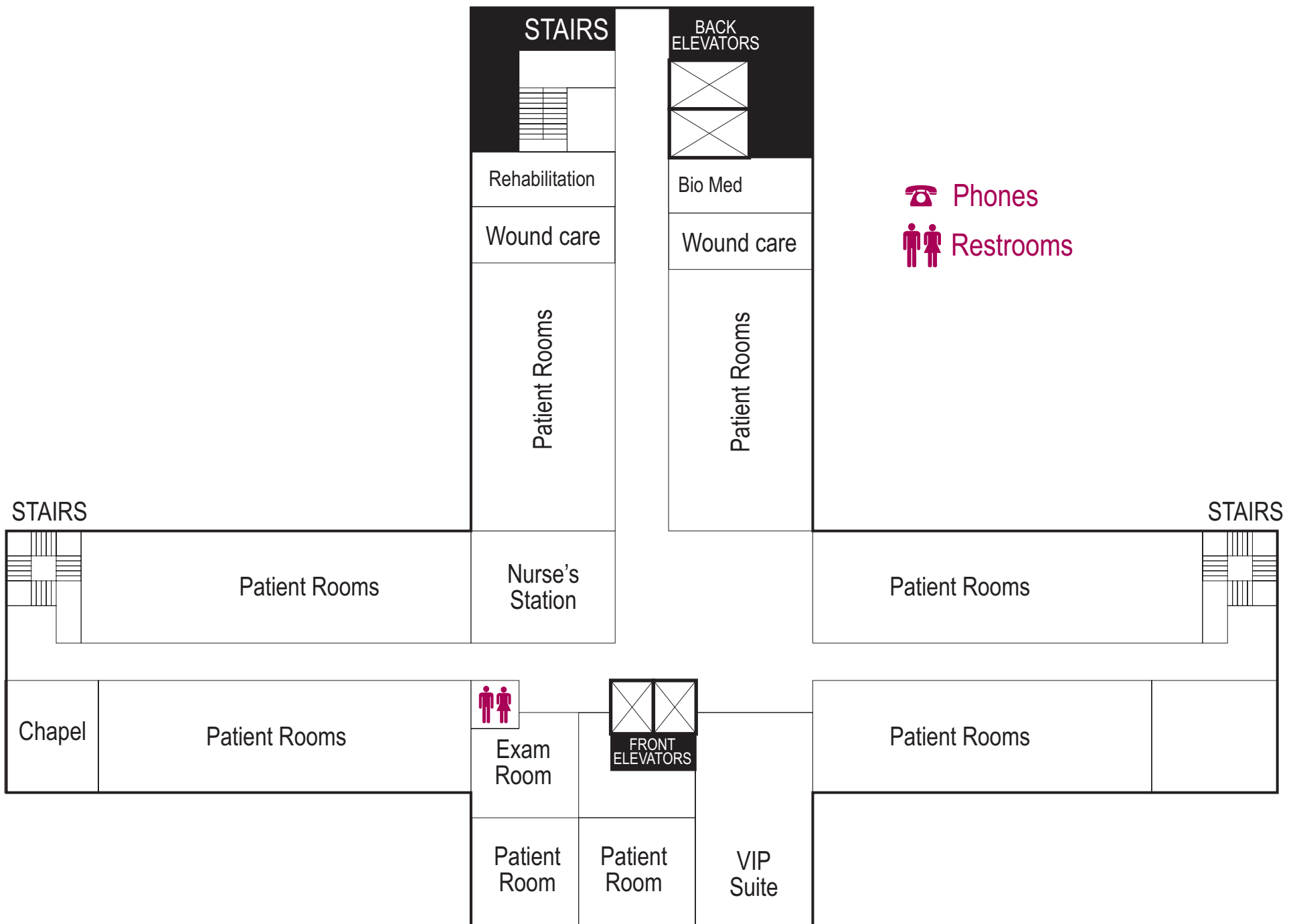

**4<sup>TH</sup>** FLOOR



# Frankfort

REGIONAL MEDICAL CENTER

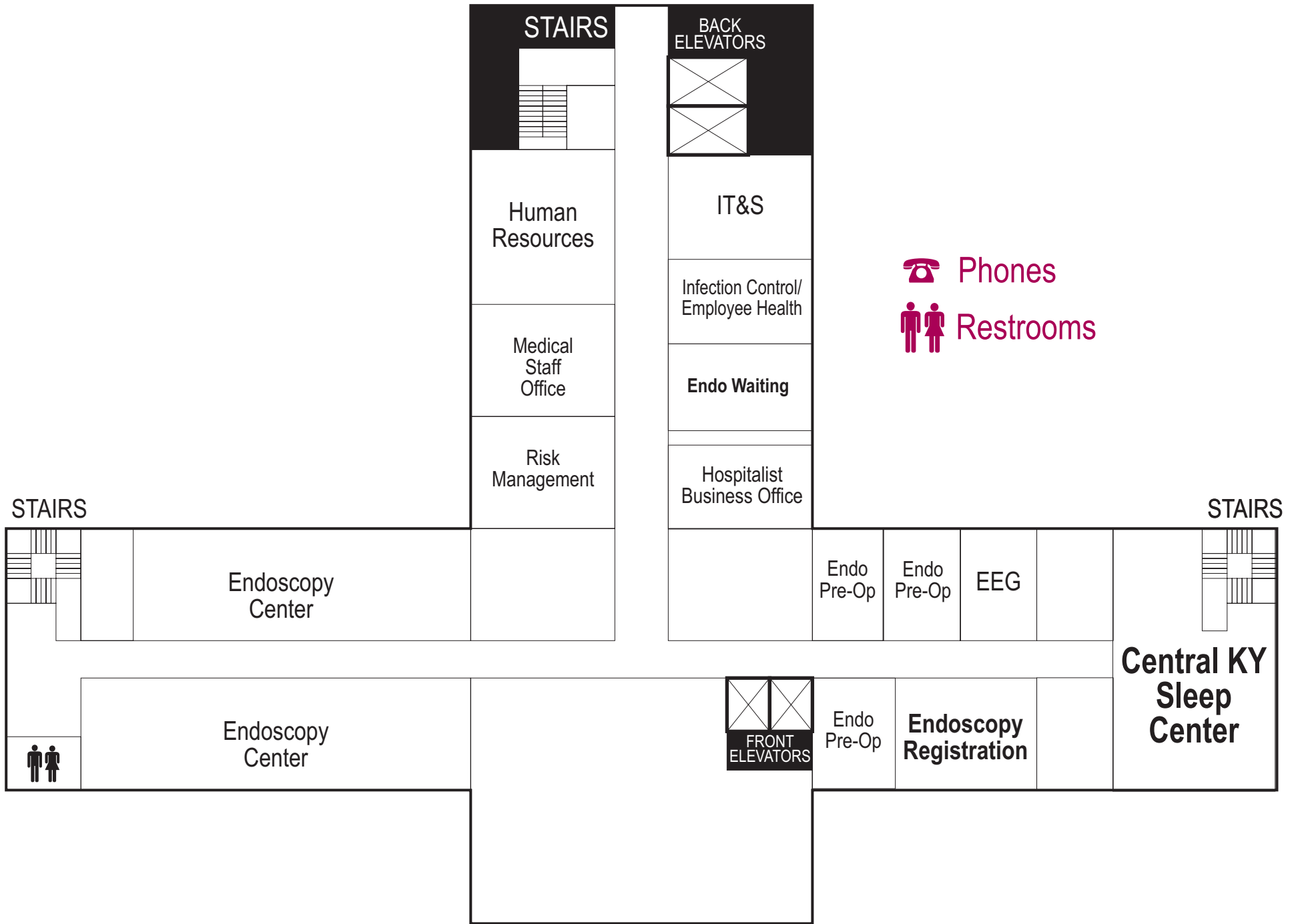

# 5<sup>TH</sup> FLOOR